

Age Range: 3-7 Yrs.
 Weight Limit: 65 Lbs.
 Surfaces: Hard surface and Grass
 Speed: Forward 2.5 & 5.0 MPH
 Reverse 2.5 MPH
 Colors: Silver Body
 Red & Black Roll Cage
 Black Tires
 Intro: 2000
 Suggested Retail: \$229.99
 Box Dimensions: 38.75" x 21" x 24.6"
 In-Box Weight: 58.8 Lbs.
 Warranty: 1 year bumper to bumper
 6 Months Battery

73180-9993

Eliminator

Advanced Series 12 Volt

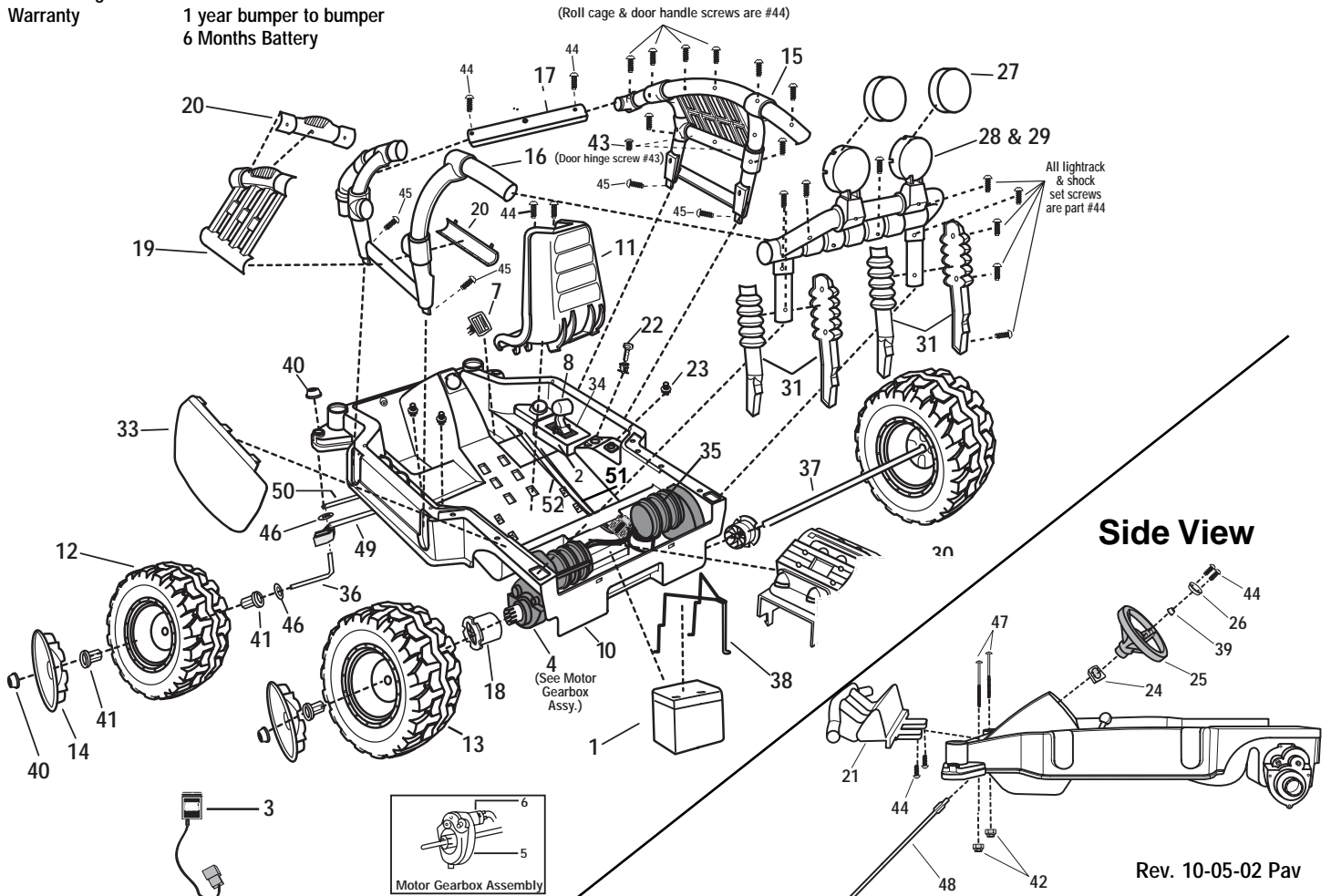

Item No.	Description	Part No.	Qty.	Item No.	Description	Part No.	Qty.	Item No.	Description	Part No.	Qty.
Working / Electrical Parts											
1	Battery 12V	00801-0638	1	22	Key Housing	74460-9369	1	45	#8 x 1-1/2" Plascrow	0801-0308	4
2	Switch Singalux (rocker type) (Shifter)	00801-0923	2	23	Dash Knob	74460-2199	3	46	7/16" Washer	0801-0196	4
3	12 Volt Probe Charger	00801-0972	1	24	Steering Wheel Collar/Stop	73180-2339	1	47	1/4"-20 x 2-3/4" Bolt	Available in Hardware bag	
4	#7 Motor GearBox Assy.	74460-9519	2	25	Steering Wheel	73180-2319	1	48	Steering Column	74790-4239	1
5	#7 Gearbox	74460-9529	2	26	Steering Wheel Button/Cap	73180-2329	1	49	Steering Linkage	74790-9219	1
6	Motor w/Pinion	74460-9579	2	27	Light Cover	Order Chrome Parts Bag		50	Crossbar	74790-4229	1
7	Footboard Assembly	73180-9389	1	28	Light Rack front and rear	73180-9189	1	51	Channel Cover (Rear)	73180-2289	1
8	Shifter Assembly	73180-9239	1	30	Decorative Engine	4000-0285	1	52	Channel Cover (Front)	73180-2279	1
Plastic Parts											
10	Vehicle Body (N/A)	73180-2109	1	31	Shock Set (left and right)	73180-951A	1	Parts Not Shown			
11	Seat	74790-2309	1	33	Fender Set	73180-9029	1	Owner's Manual	73180-0920	1	
12	Front Wheel	74790-2469	2	34	Shifter Cover	73180-2299	1	Large Parts Bag (molded Parts)	73180-9039	1	
13	Rear Wheel	74790-2459	2	35	Motor Cover (Hi-Eff)	76803-2489	2	Chrome Parts Bag	73180-9249	1	
14	Hubcap	Order Chrome Parts Bag		Hardware							
15	Rollcage / Right (w/oScrews)	73180-9069	1	36	Front Axle	74790-4509	2	Small Parts Bag (purchased parts)	73180-91391		
16	Rollcage / Left (w/o Screws)	73180-9049	1	37	Rear Axle (length 32")	74790-4519	1	Decal Sheet	73180-0310	1	
17	Sound Bar	73180-9449	1	38	Battery Retainer	74790-4019	1	Footswitch (Plunger type)	00801-0933	1	
18	Wheel Driver, 10 rib	74460-2249	2	39	.354 Cap Nut (Black)	0801-0604	1	Mylar Black Decal Sheet	73180-0320	1	
19	Door	Order Chrome Parts Bag		40	.437 Cap Nut (Black)	0801-0226	6	Hardware	73180-9279	1	
20	Door Handle / Hinge Set	73180-2999	1	41	Hex Bushing	73233-2559	6	Pw Emblem	74460-9069	1	
21	Brushguard	73180-2129	1	42	1/4" Nyloc Nut	Order Hardware bag		Wiring Harness	74790-9699	1	
				43	#8 x 1/2" Screw	0801-0202	2				
				44	#8 x 3/4" Screw	0801-0223	10				
					(10 of the 3/4" Screws are factory assembled)						
					#8 x 3/4"	0405-2073	40				

N/A = Not Available **Bold and Underline parts are Service Center Parts only**

